

Specification of: RWM 57-5663-6W-16

Smoke extract wall fan murovent with external HIGH EFFICIENCY motor in efficiency class IE 2 (IEC 60034-30)

with horizontal discharge suitable for smoke extraction in the case of fire for temperatures up to +600 °C, 120 min. Tested and certified to DIN EN 12101-3 - Certificate No 0036-CPR-RG01-17. Casing made of rugged galvanized steel sheet. Intake cone made of galvanized steel sheet and with connection to flange acc. to DIN 24155-2 Discharge with guard. Backward curved impeller of welded, coated sheet steel construction, All parts under mechanical stress made of galvanized steel oder painted. Motor completely out of hot gas area and cooled by outside air. Feed line loose cable to motor connection box.



Technical data of the fan: RWM 57-5663-6W-16

EU regulation 1253/2014 not applicable

Description	Value Dimension
Specified duty point	
Actual duty point	
Installation acc. DIN 24163 Part 1	C
Reference density (Rho1)	1.15 kg/m ³
Medium temperature (t)	20 C
Fan weight	192 kg
Rated data	
Phases-Voltage-Frequency	3~230/400-50 V-Hz
Frame size-poles:	100La / IE2-6
Motor rating (P _N)	1.5 kW
Rated motor speed (n _N)	970 min ⁻¹
Rated motor current (I _N)	6,4/3,7 A
Max. temperature t _{max} , admitted for 120 min only	600 C
operational limits	
Max. fan speed (n _{vmax})	1000 min ⁻¹
Max. operating frequency (f _{max})	50 Hz
Temperature range of conveying medium (t _{min} ...t _{max})	-20...80 C

Fan curve to RWM 57-5663-6W-16

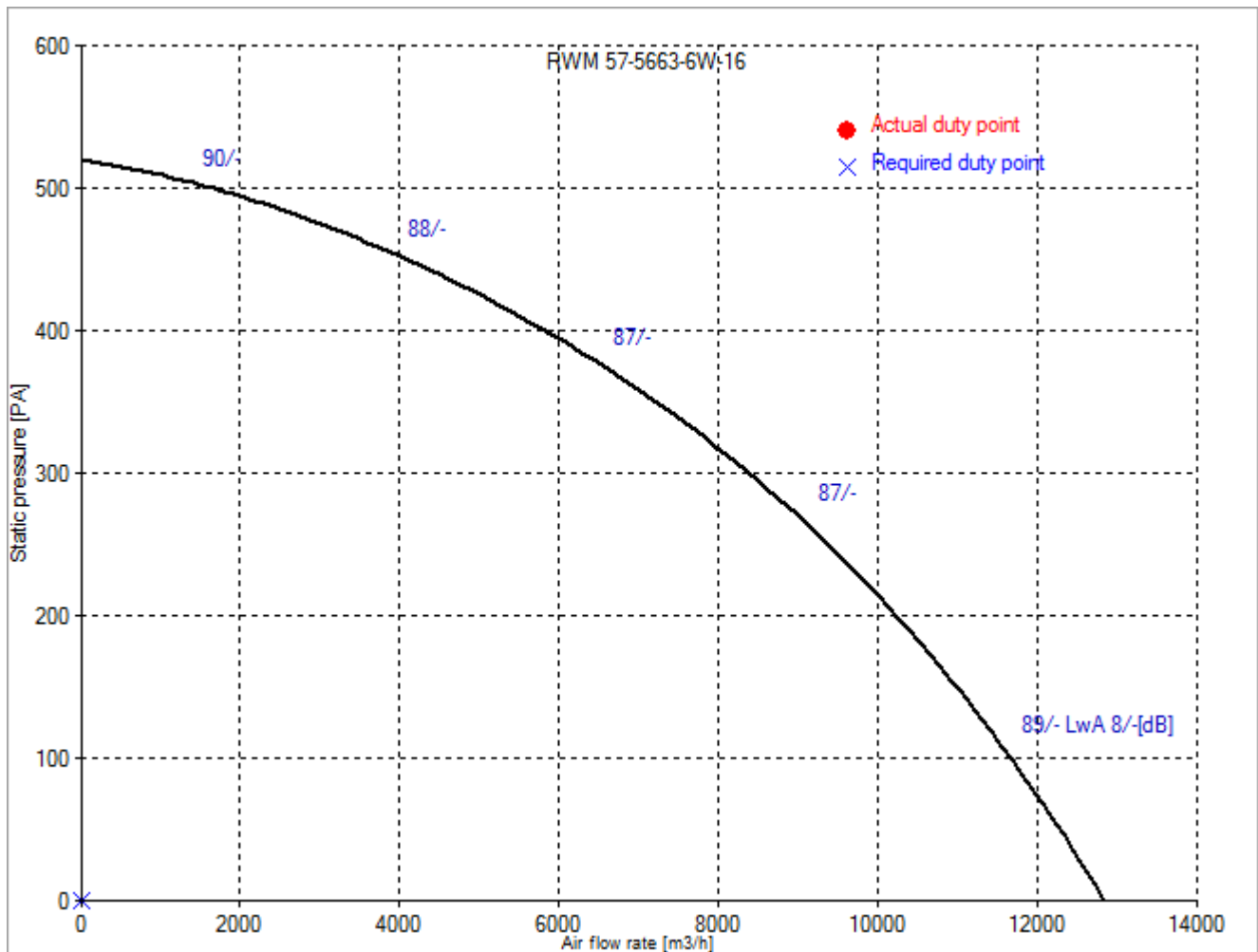

Dimensions to RWM 57-5663-6W-16

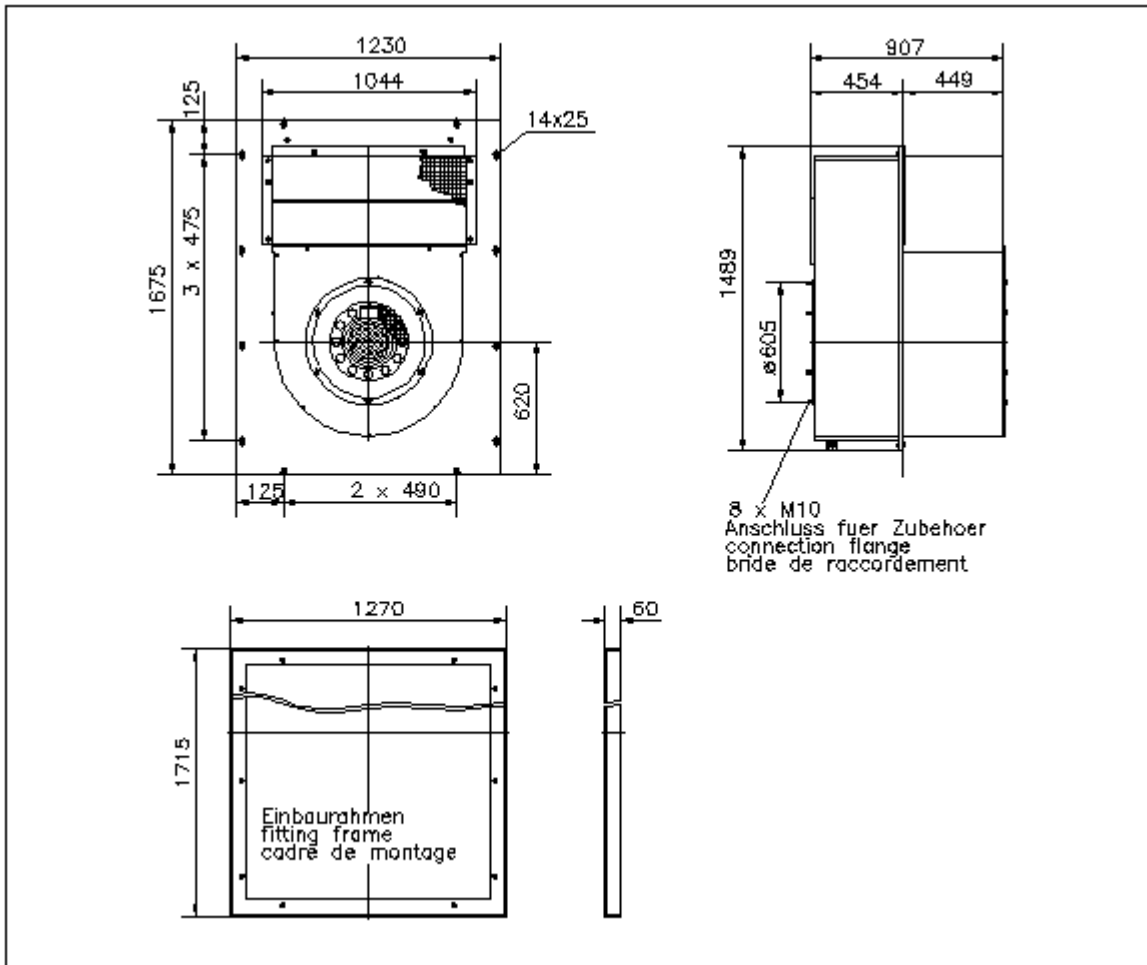

Rotation:
Handing:

RD
90